

FAMILY

TENNESSEE

MURFREESBORO

CENTRAL

Rutherford Park

554 Agripark Drive Murfreesboro, TN 37128

Office: 615.785.3759 | Fax: TBD

Email: rutherfordpark@wilhoitproperties.com



OVERVIEW

Home Type: Apartment Homes

Bedrooms: 2–3

Bathrooms: 2

Size: 1351 – 1447 ft²

Built In: 2020

Property Description

Welcome home to Rutherford Park, nestled in beautiful Murfreesboro, TN. We offer brand new 2 & 3 bedroom apartment homes that are close to schools, grocery stores & shopping. Proudly offering a community that fits your lifestyle with apartments that feature fully-equipped kitchens and include a full size washer & dryer. Large open floor plans with spacious closets, ceiling fans and private sun-rooms finish your home perfectly. A game room, fun playground, cardio fitness center, media center with computers a sparkling swimming pool, picnic areas with grills an din-site staff to care for your needs. More than an apartment, we are a community of neighbors living life together. Make the change to Rutherford Park and live life to the fullest.

Schools

District: Murfreesboro City Schools

AMENITIES

Units:

Large Floor Plans

Ceiling Fans

Fully-Equipped Kitchen

Washer & Dryer Included

Pet Friendly *fees & limitations apply

Property:

24-Hour Emergency Maintenance

Playground

Swimming Pool

Picnic Area with BBQ Grills

Dog Park

CONNECT WITH US

 @Wilhoit.Properties

 Wilhoit Properties, Inc.

 Wilhoit Properties

FLOOR PLANS

**2 bedroom
2 bathroom
1351 sq ft**

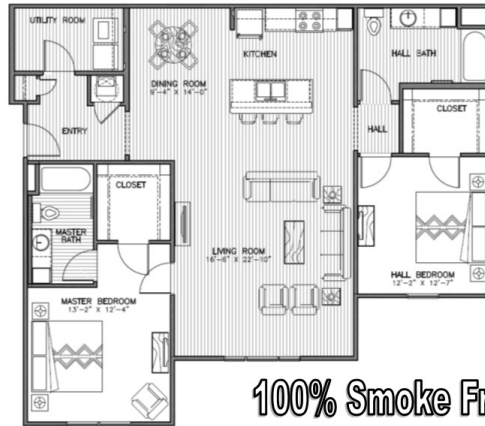

**3 bedroom
2 bathroom
1447 sq ft**



OWNERSHIP & PARTNERS

Developer



Property Manager



Construction Management



Other Partners:

Tennessee Housing Development Agency
KeyBank
FRE Community Equity Fund 1 LP

CREDIT CARD PAYMENTS

The following credit cards are accepted forms of Rent Payment but are ONLY processed in person at Property Offices.

